

Index

Box 30 to 96

#13-30 Deon Square

#13-31 Shop_Wal

#13-31 Wal-Mart

#13-32 Hidden Forrest

#13-33 Orangewood Apt

#13-34 NewFallsRd

#13-35 Five Points

#13-36 Emilie Rd

#13-90 Grundy Gardens

#13-91 Truman & C.Barton

#13-92 Franklin&Emerson

#13-93 Washington&Magic Cot

#13-94 BCTS & Egan

#13-95 Armstrong

#13-96 Immaculate

Deon Square Center
502 thru 550 S. Oxford Valley Rd

13-30

1st Due
E13,E77,E32
L31,L30,R10
SQ154
Rit R8

2nd Alarm
E31,E12,E82
L14,L33
R32

Notes:
Will have to block Oxford Valley Rd
with any lines dropped.
Hydrant at 489 Pheasant Ln can be
reached from side "C" through yard
to Pheasant Ln.

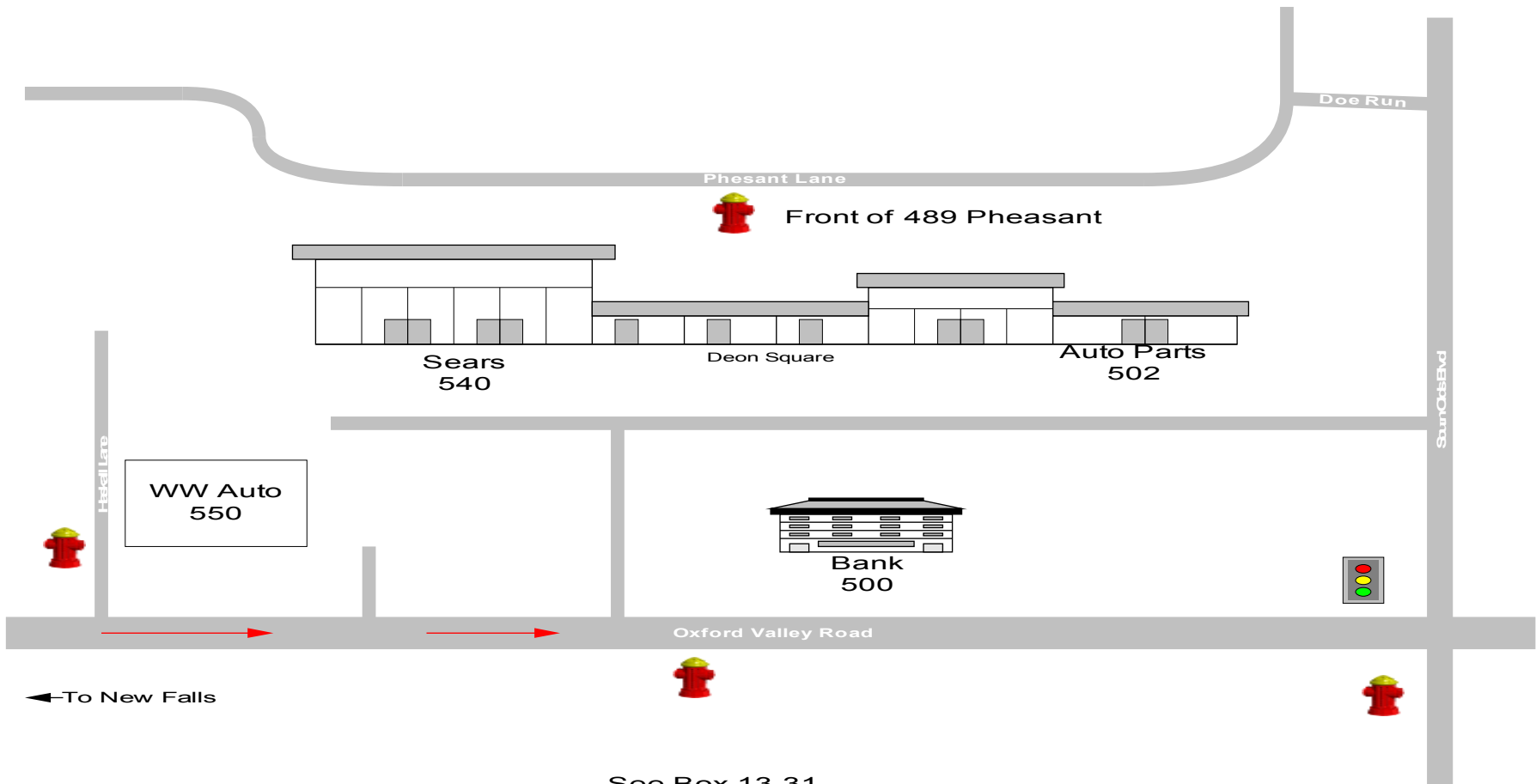

See Box 13-31

#Index Index

Shop Rite Center
501 thru 549 S. Oxford Valley Rd

Wal-Mart
495 S. Oxford Valley Rd

13-31

1st Due: E13,E77,E32
L31,L30,R10,Sq154
Rit R8

2nd Alarm: E31,E12,E8
L14,L33,R53
Rit R9

Notes:
Metal Truss Roofs and
False Fronts
Wal-Mart FDC Side A
Shop Rite FDC Side C

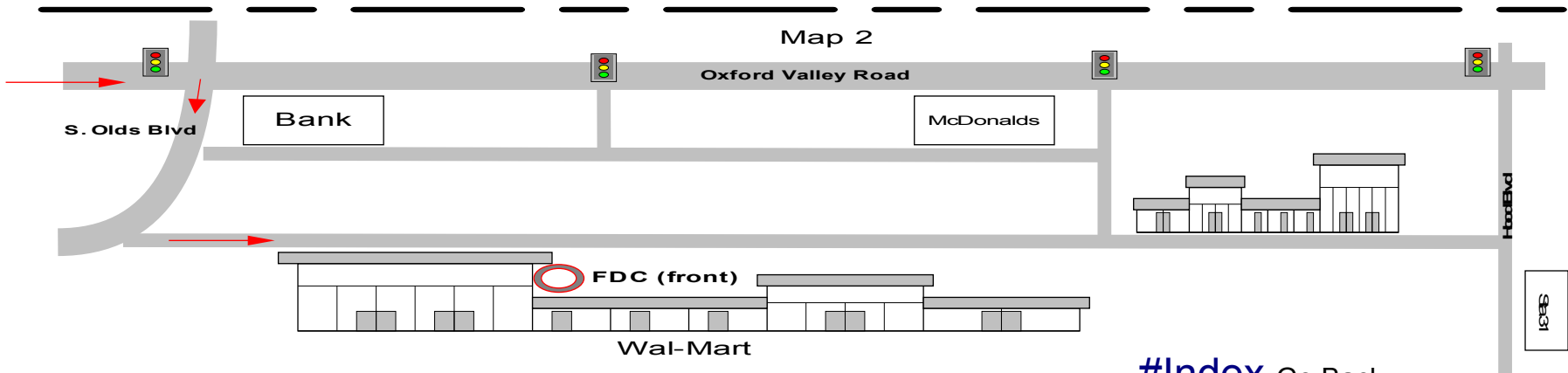
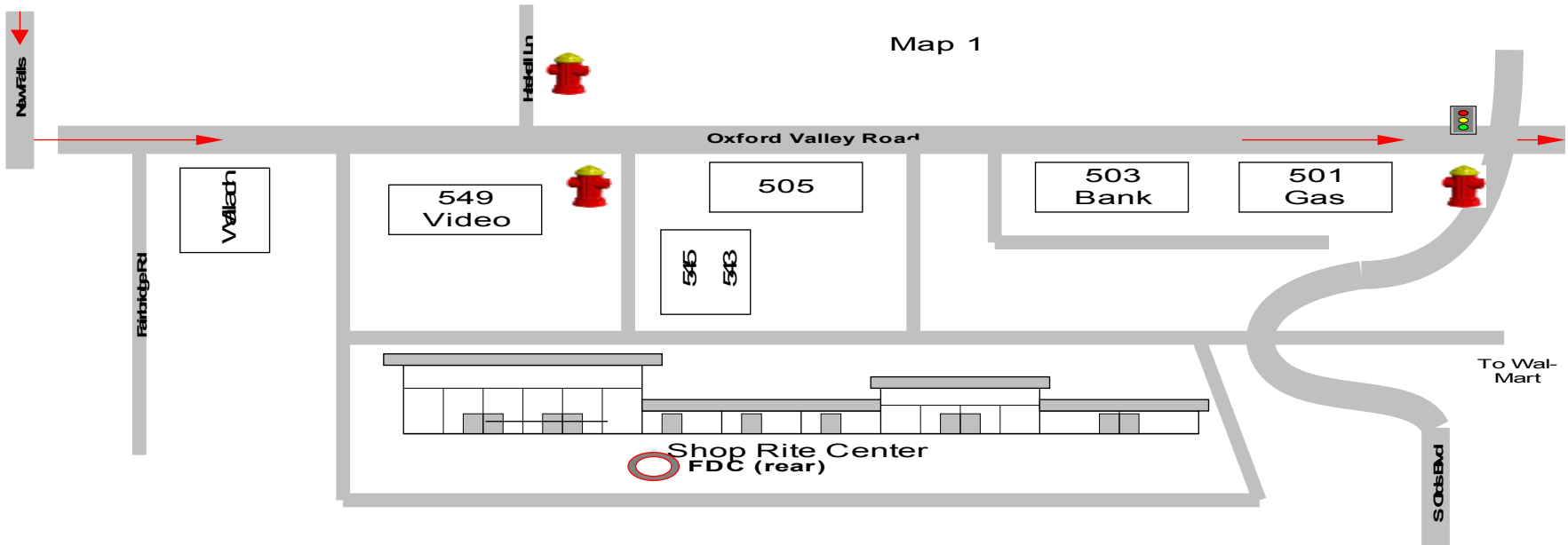

[#Index](#) Go Back

Wal-Mart

LEVITTOWN FIRE COMPANY #2

Location: **Wal Mart** 495 Oxford Valley Road BID 500, Fairless Hills PA
(215) 949-6600

BOX 13-31

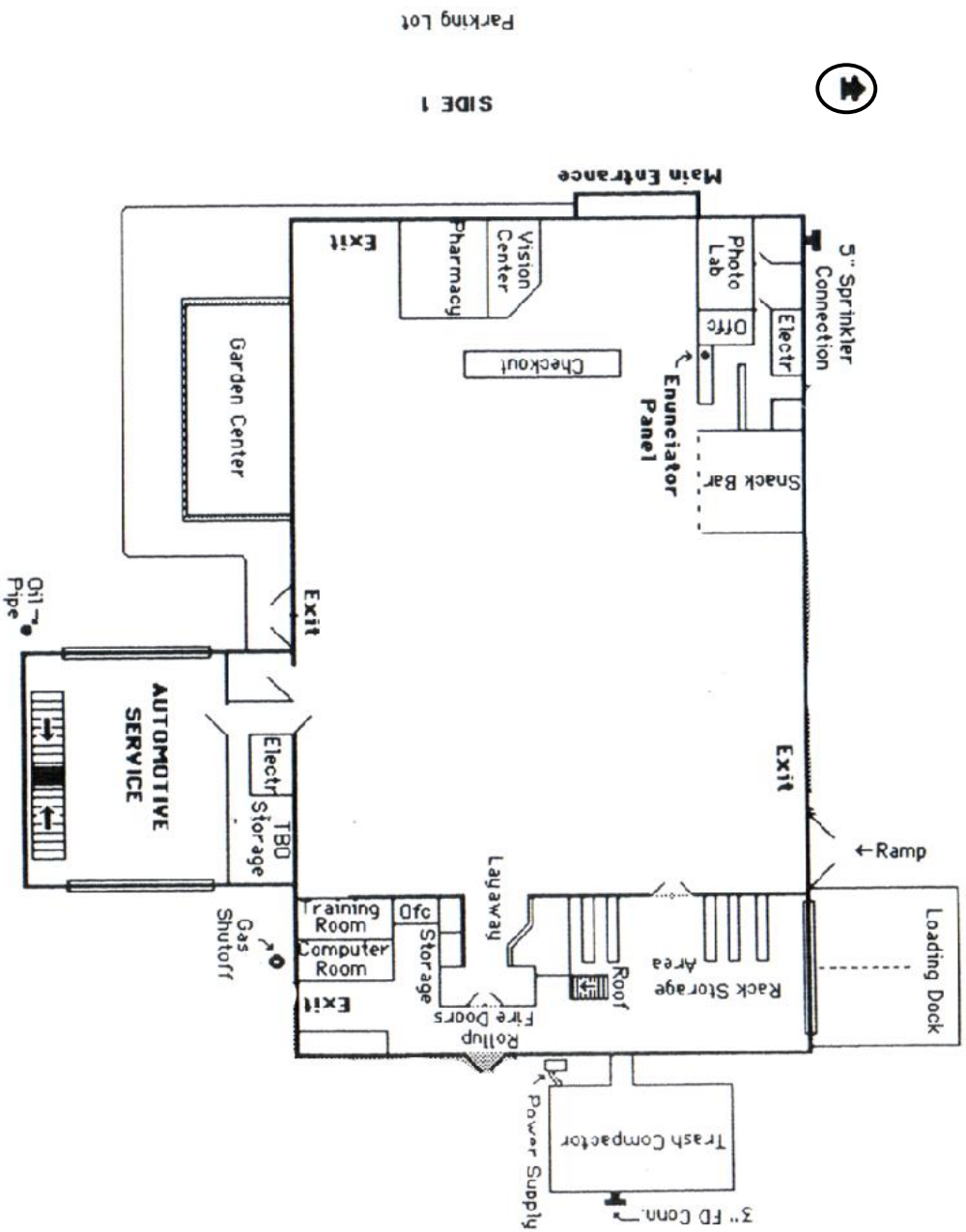

Parking Lot
SIDE 1

HYDRANT LOCATIONS

- Corner 1,2 at Sprinkler Connection
- Corner 1,4
- Side 3 near Automotive Center
- South Olds Blvd at Grundy Gardens
- Oxford Valley Rd near main entrance

SPECIAL INFORMATION

- Sprinkler Connection located Corner 1,2
- 3" FD Connection installed onto side of trash compactor
- Up to 10000 gals. of new and used oil in bulk tanks located beneath service bays
- Main gas shutoff located Corner 3,4

1st Due:
E13,E77,E32
L14,L31
R10,SQ154
Rit: L30

Hidden Forrest Court

545 Wistar Road

Contact #

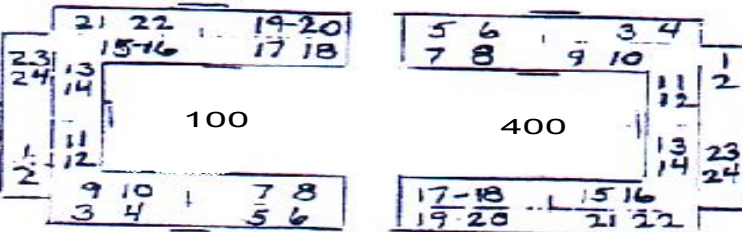
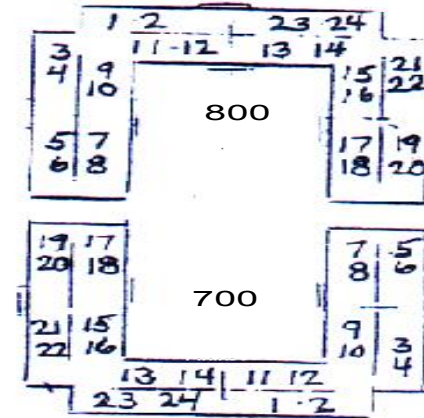
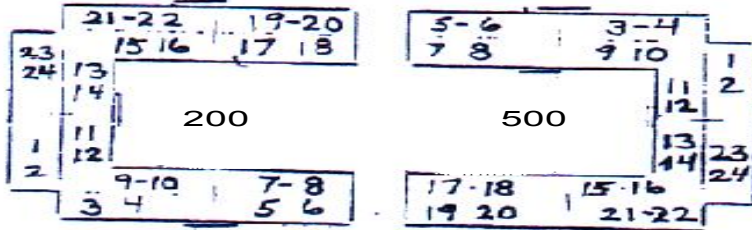
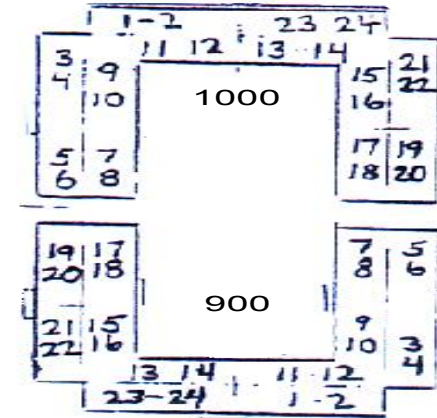

359

Queen Anne Dr

Parking Lot

Tennis



1st Due:
E13,E32,E82
L10,L14
R31,SQ154
Rit L30

Orangewood Apts

2nd Alarm:
E30,E12,E
L8,L53
R10
Rit:E11

13-33

New Falls

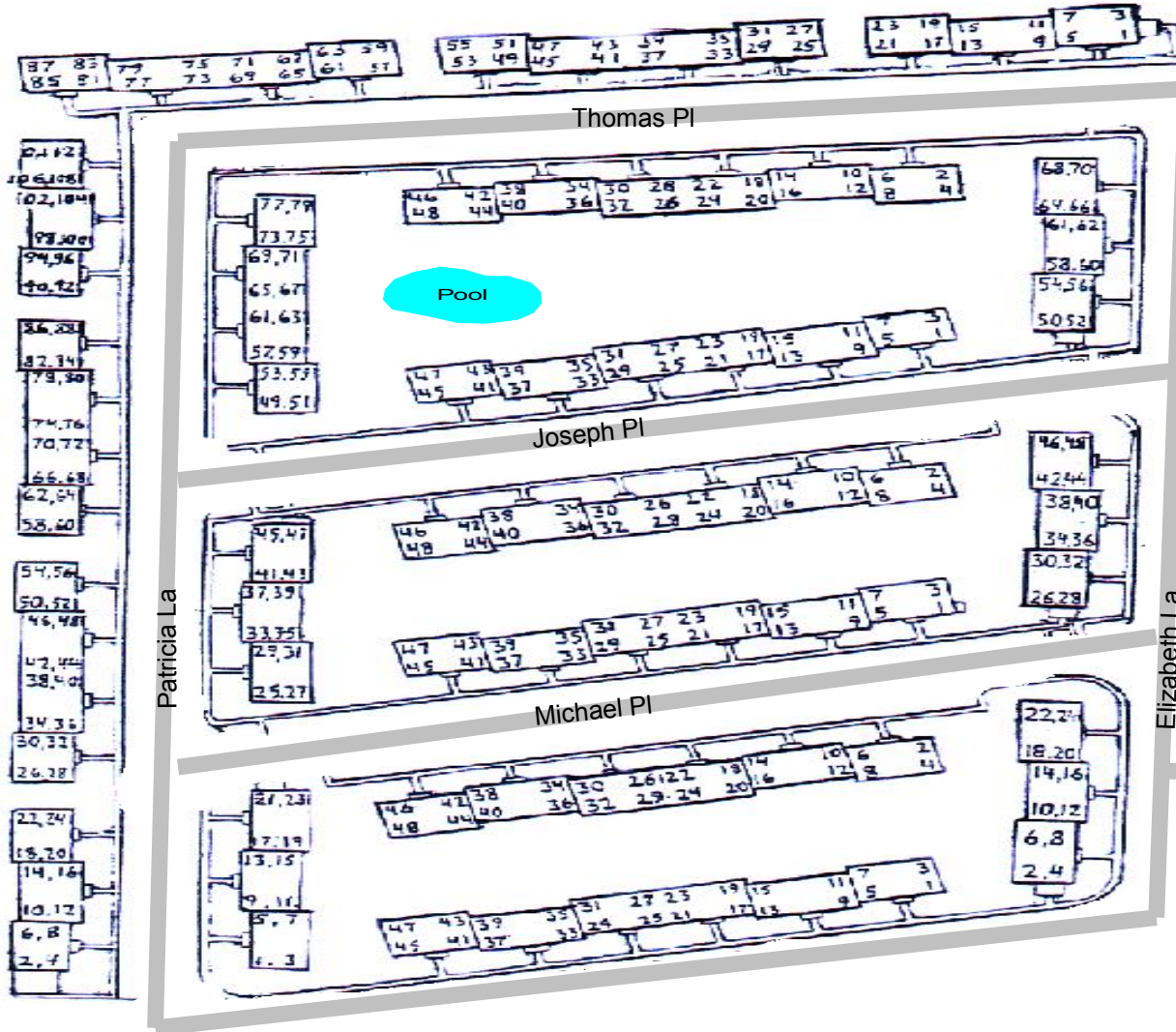

Old Pond



Old Brook



To Green La

Mill Creek Pkw

#Index Go Back

1st Due:
E13,E77,E32
L30,L31
R10,Sq154
Rit R8

7300 thru 7901 New Falls Rd Verizon

2nd Alarm:
E12,E31,E7
L14,L33
R32

13-34

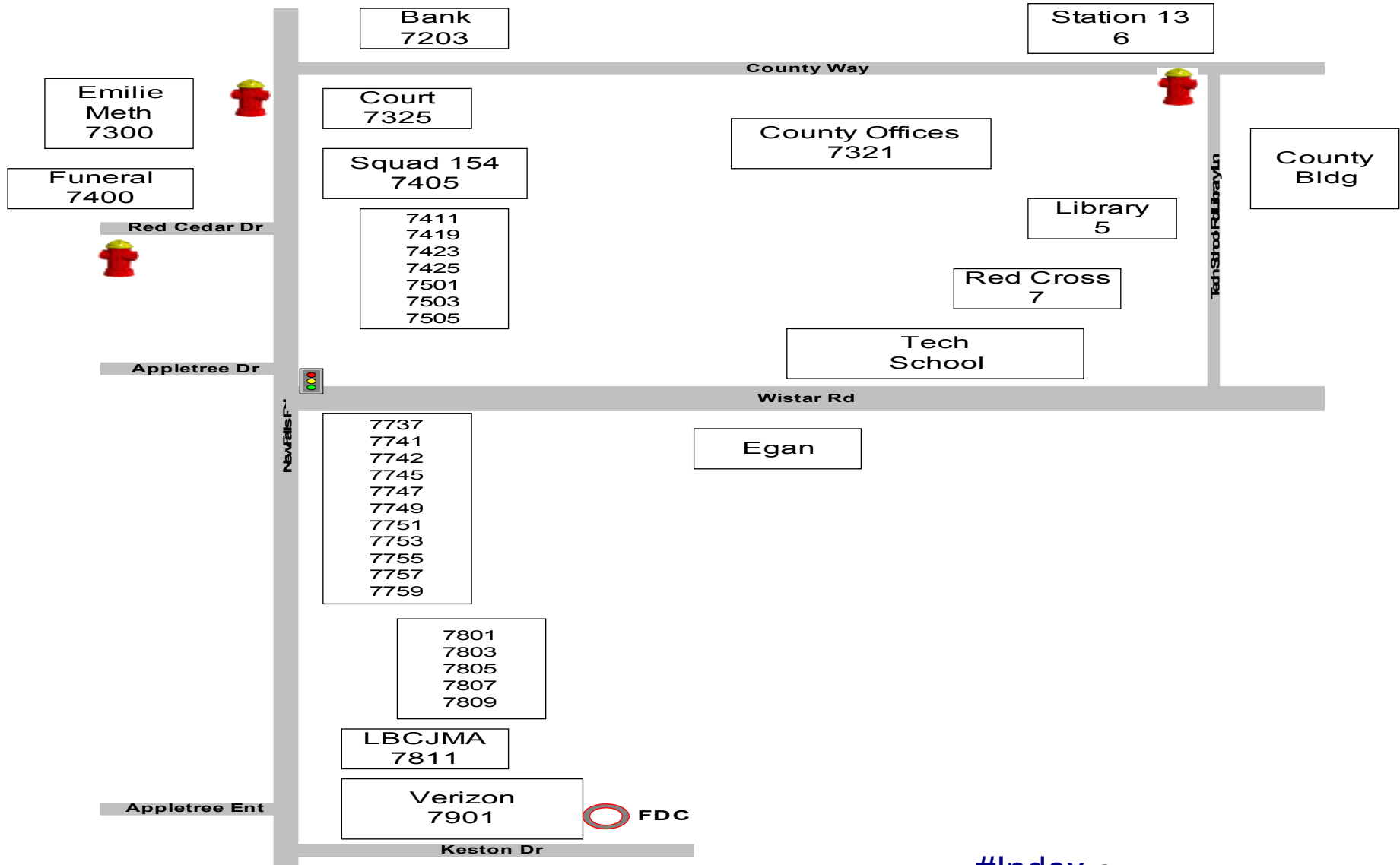

1st Due:
E13,E77,E12
L10,L14
R31,Sq154
Rit: R8

5 Points Area

6928- 6896 Emilie Rd,4119-4153 Woerner
6524-7230 New Falls,4214-4218 Woodbourne

2nd Alarm:
E82,E32,E10
L30,L31
R53

13-35

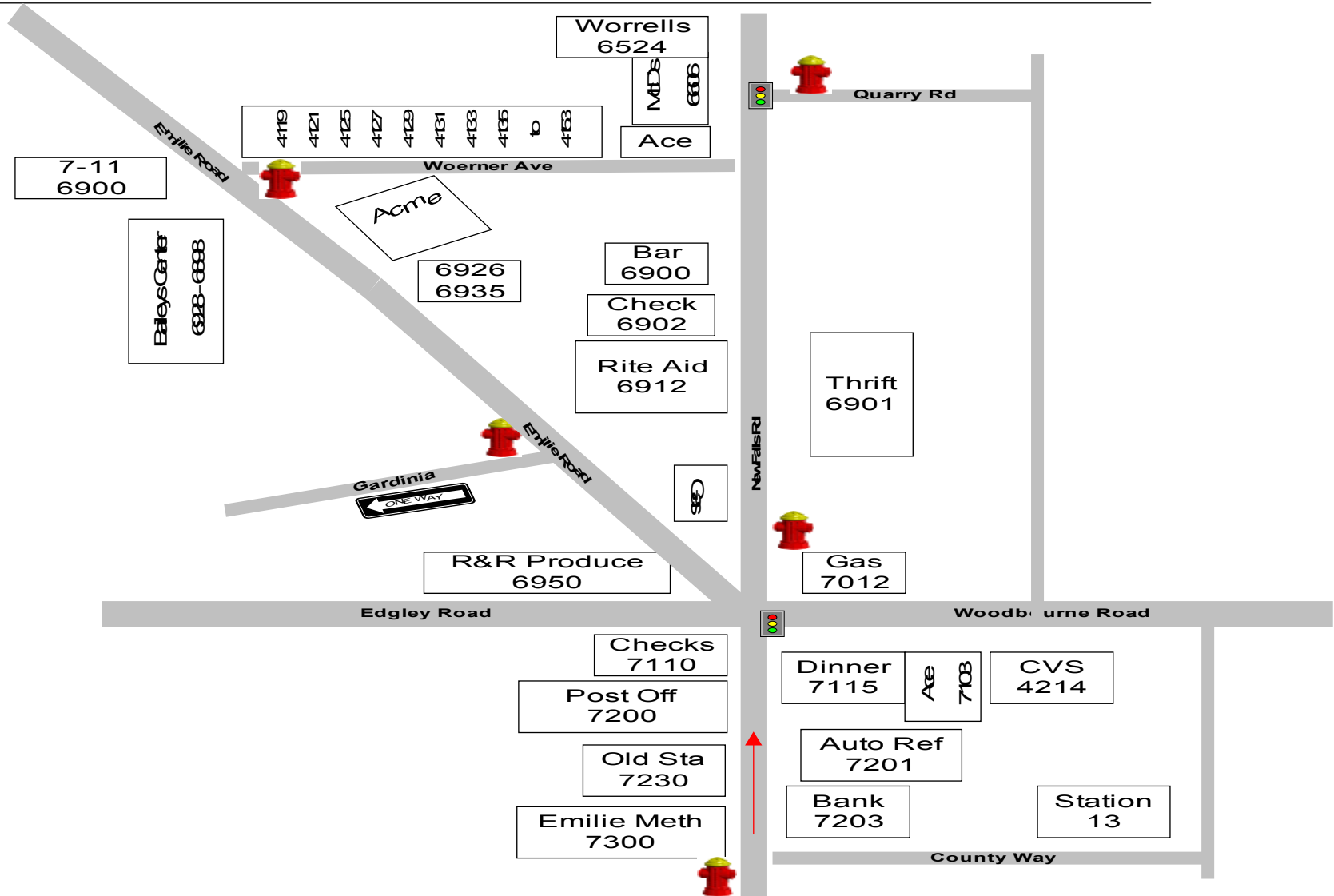

[#Index](#) Go Back

1st Due:
E13,E82,E77
L10,L14
R12,Sq154
Rit: R8

5900-6200 Emilie Rd

Note:
Hydrant at 21 Ice Pond
Can be hand stretched to/
from Emilie Rd
@ Color Crafters

13-36

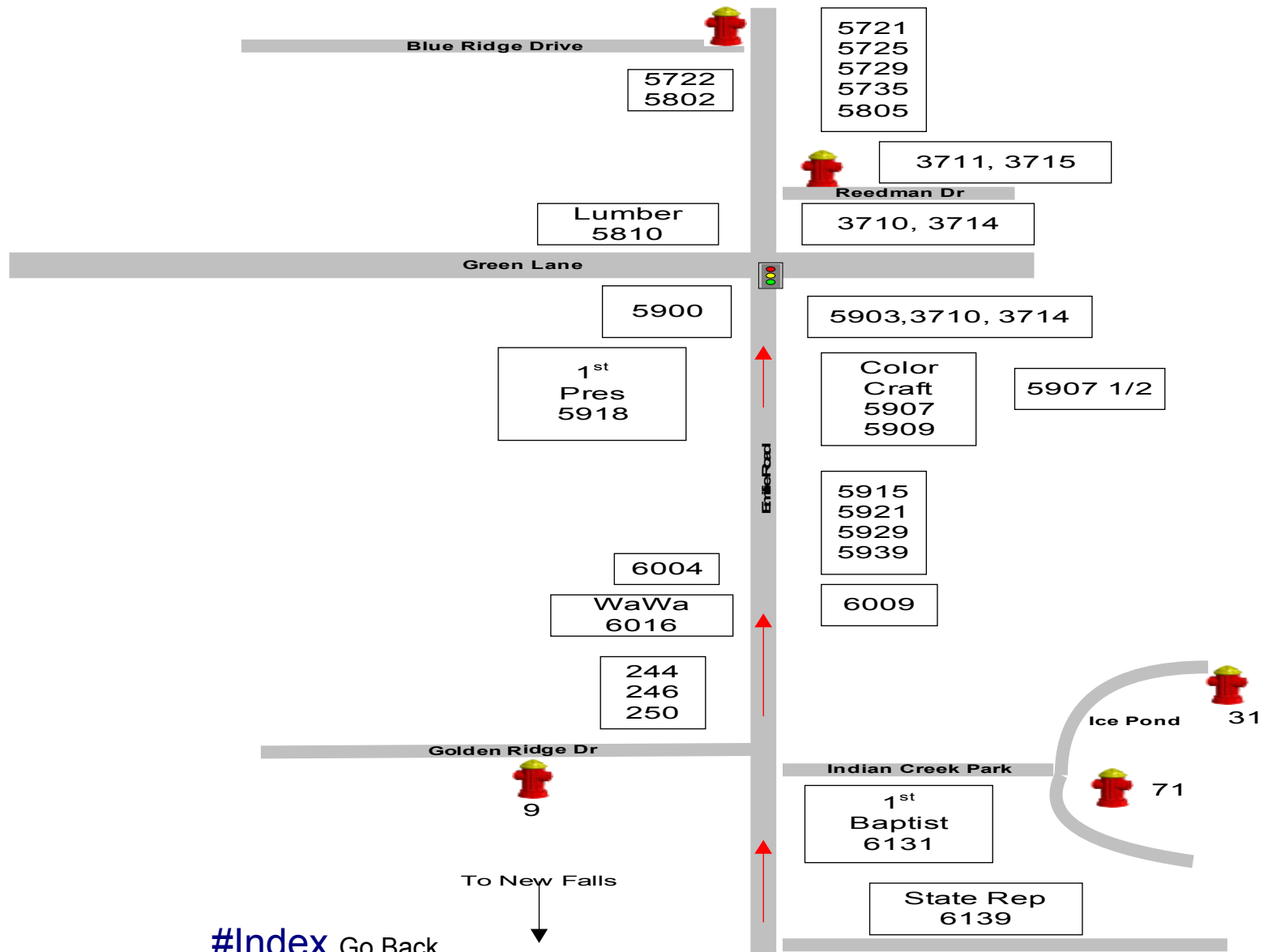

[#Index](#) Go Back

To New Falls

Grundy Gardens/Lamont Plaza/ Kinder Care

13-90

Address: 430 S. Olds Blvd
500 thru 508 Hood Blvd

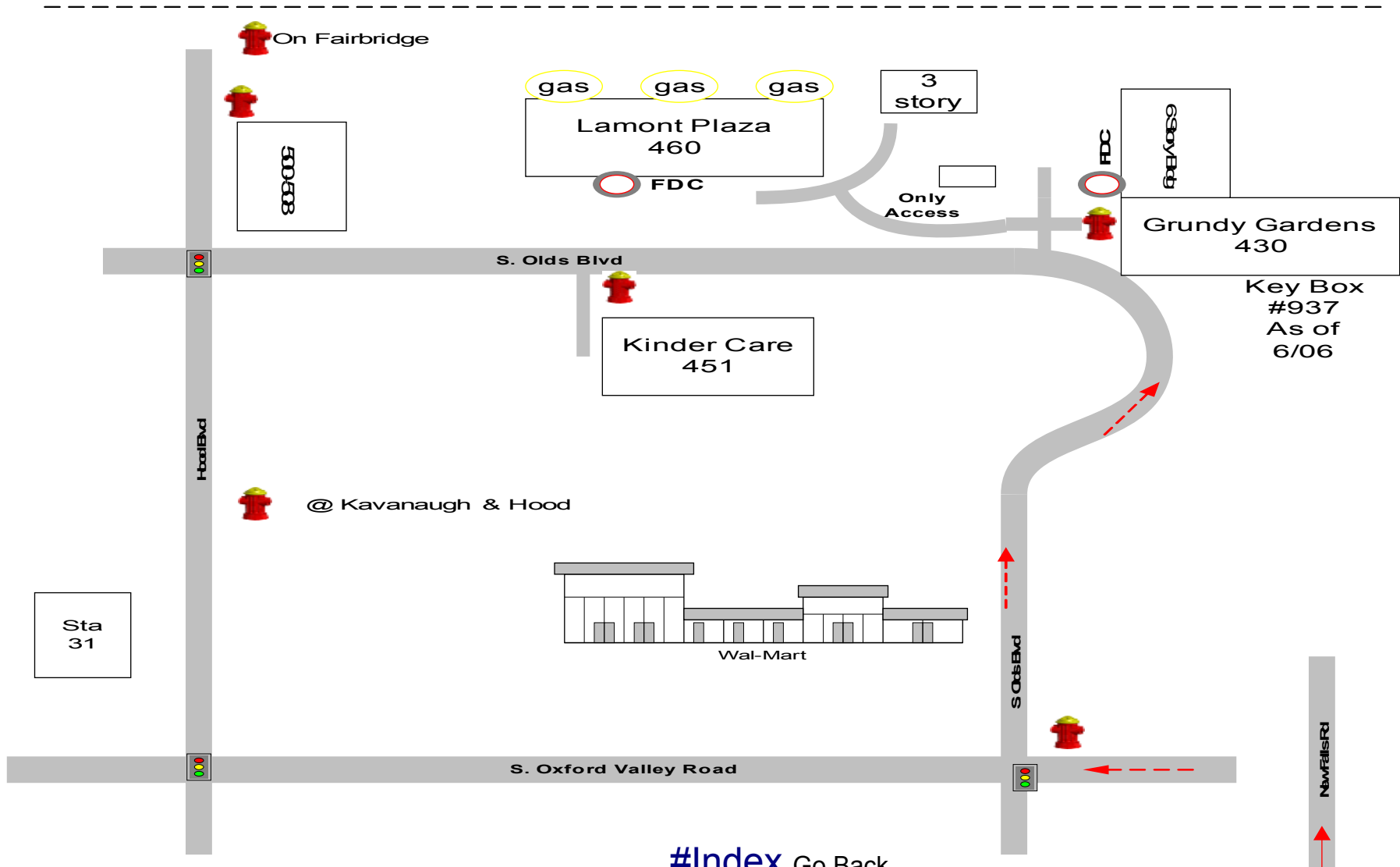

[#Index](#) Go Back

Truman High School Clara Barton Elem School

13-91

1st Due:
E13,E82,E32
L10,L14
R31,R53,SQ154
Rit: E11

Address: 1701 Green Lane
Address: 5 Blue Lake Road

2nd Alarm:
E10E12,E52
L33,L51
R8

Note: Barton must be accessed via Blue Ridge Dr

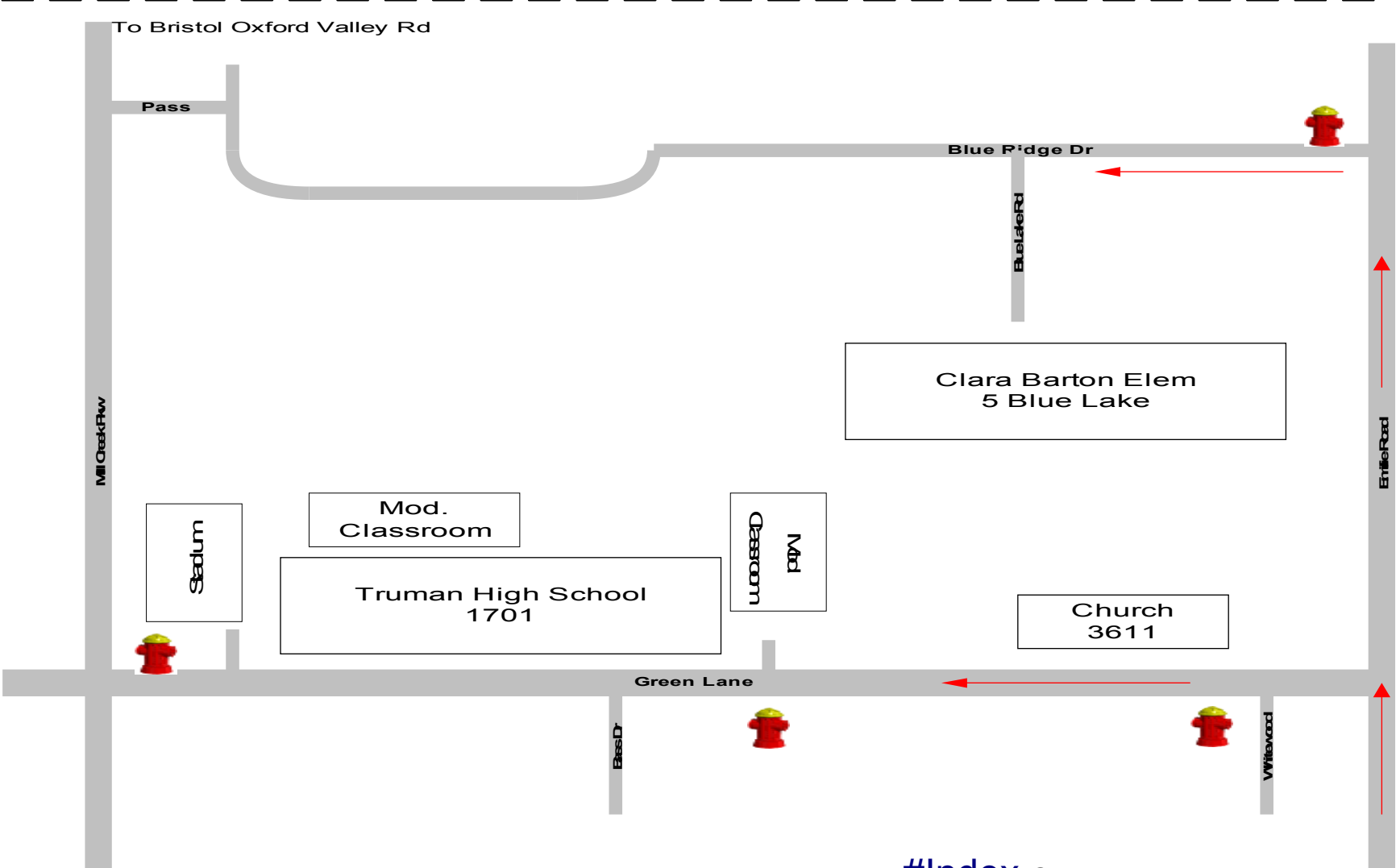

Franklin Middle School
Address : 6403 Mill Creek Pkw
Emerson Elementary School
Address : 6501 Mill Creek Pkw

13-92

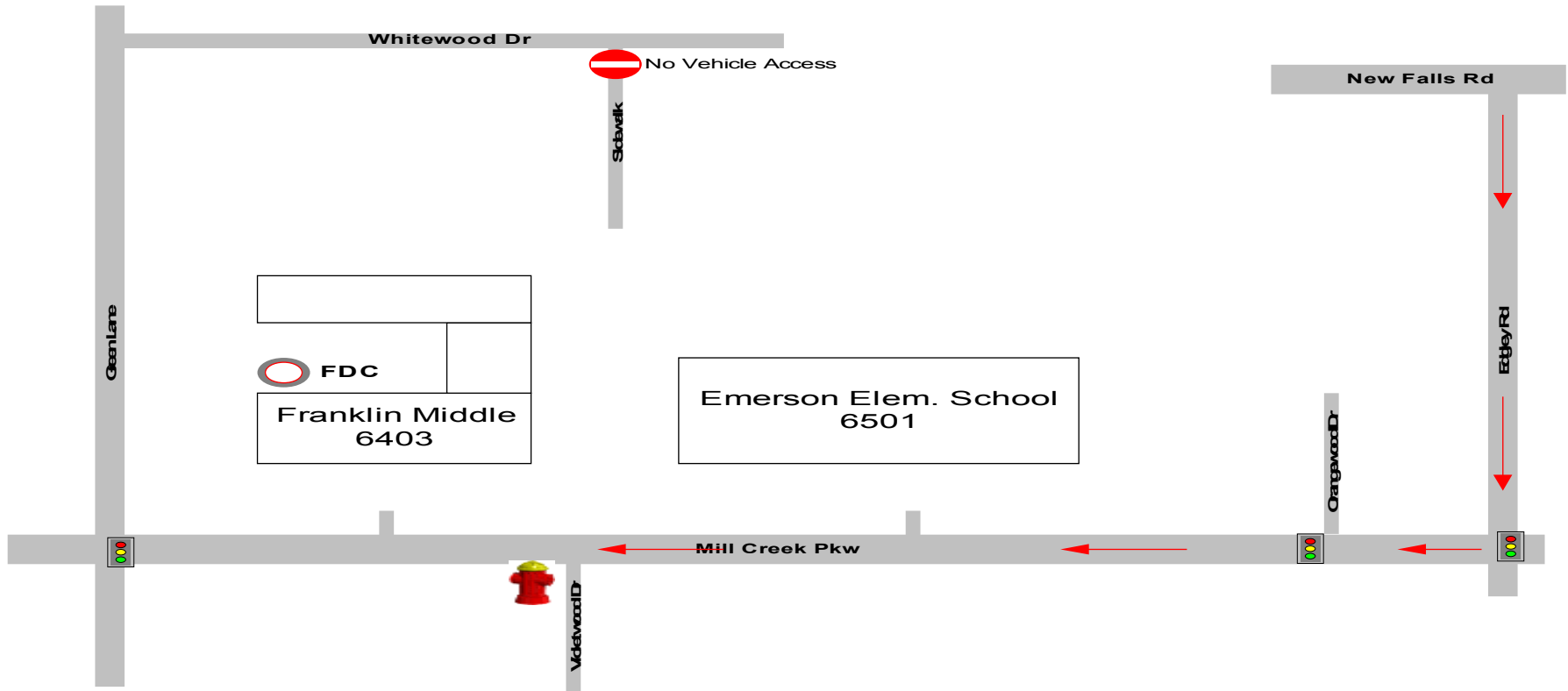

Washington Elem School Magic Cottage

13-93

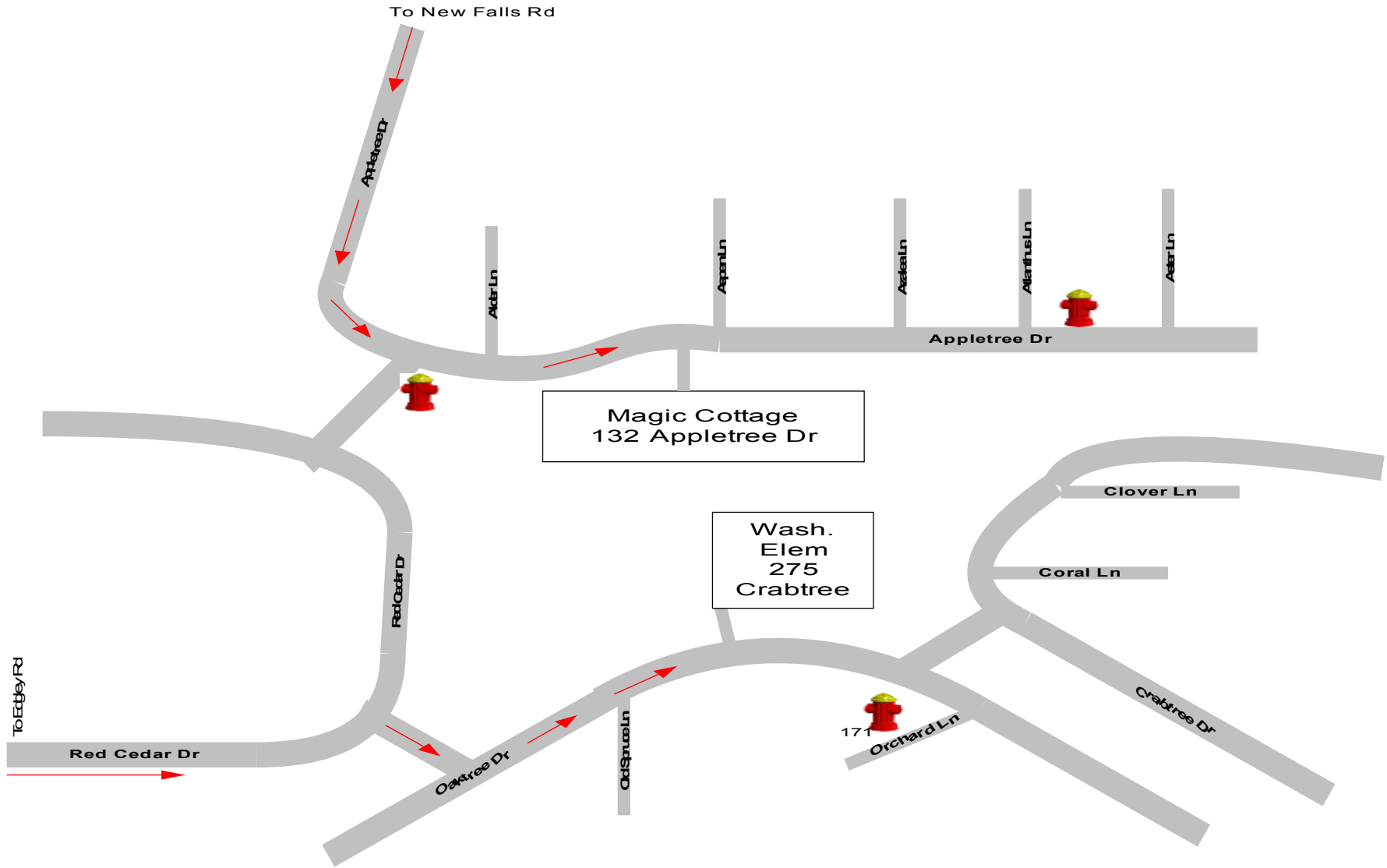

1st Due:
E13,E77,E10
L31,L14
R32,R31,SQ154
Rit: R8

Bucks Co. Tech School Conwell-Egan High School

13-94

2nd Alarm:
E12,E82,E30
L33,TW44
R98

*Station 13 has key for gate

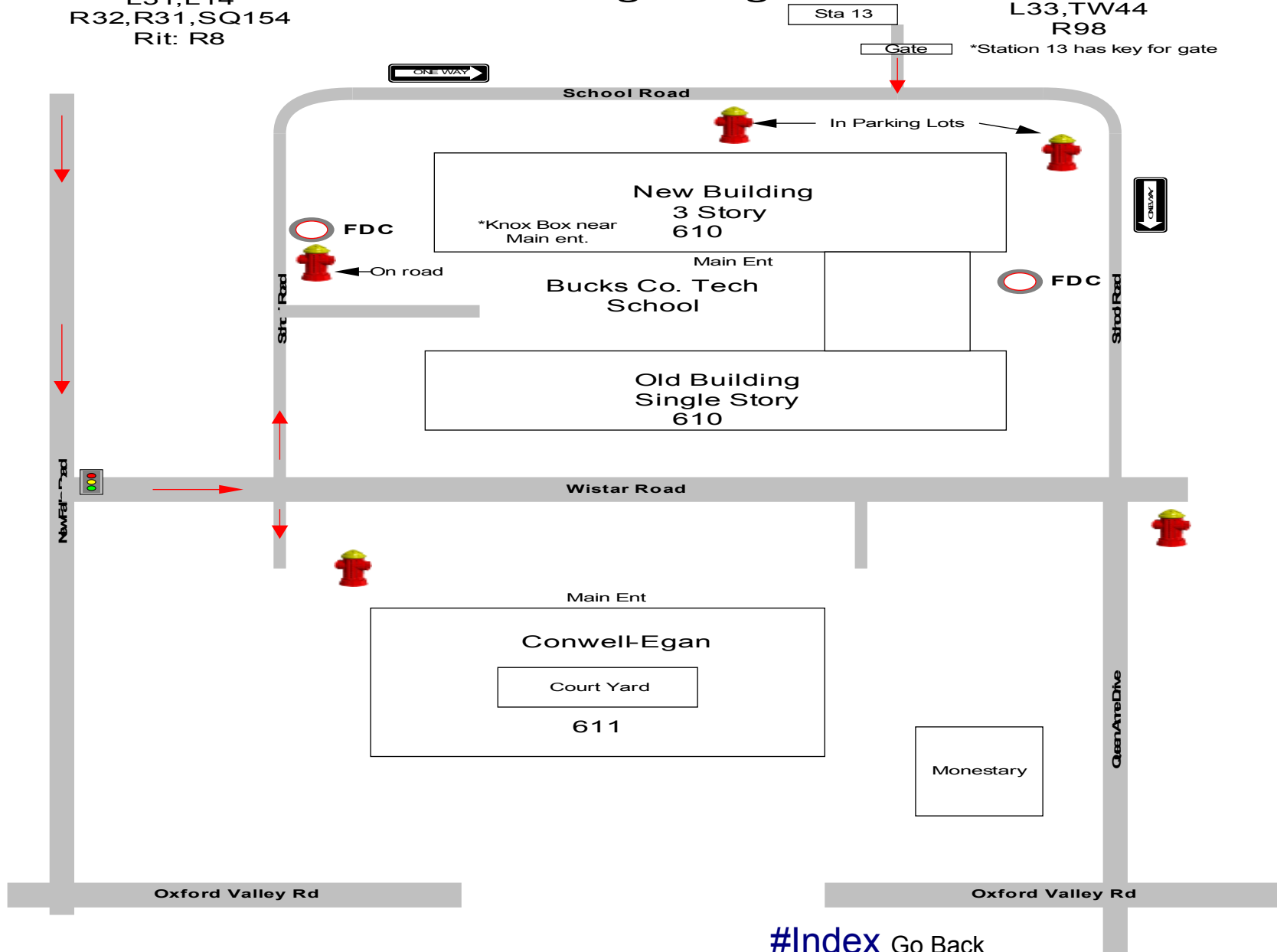

Neil Armstrong Middle School
475 Wistar Road

13-95

1st Due:
E13,E77,E30
L31,L14
R10,R31,SQ154
Rit: R8

2nd Alarm:
E12,E82,E7
L30,L10
R98

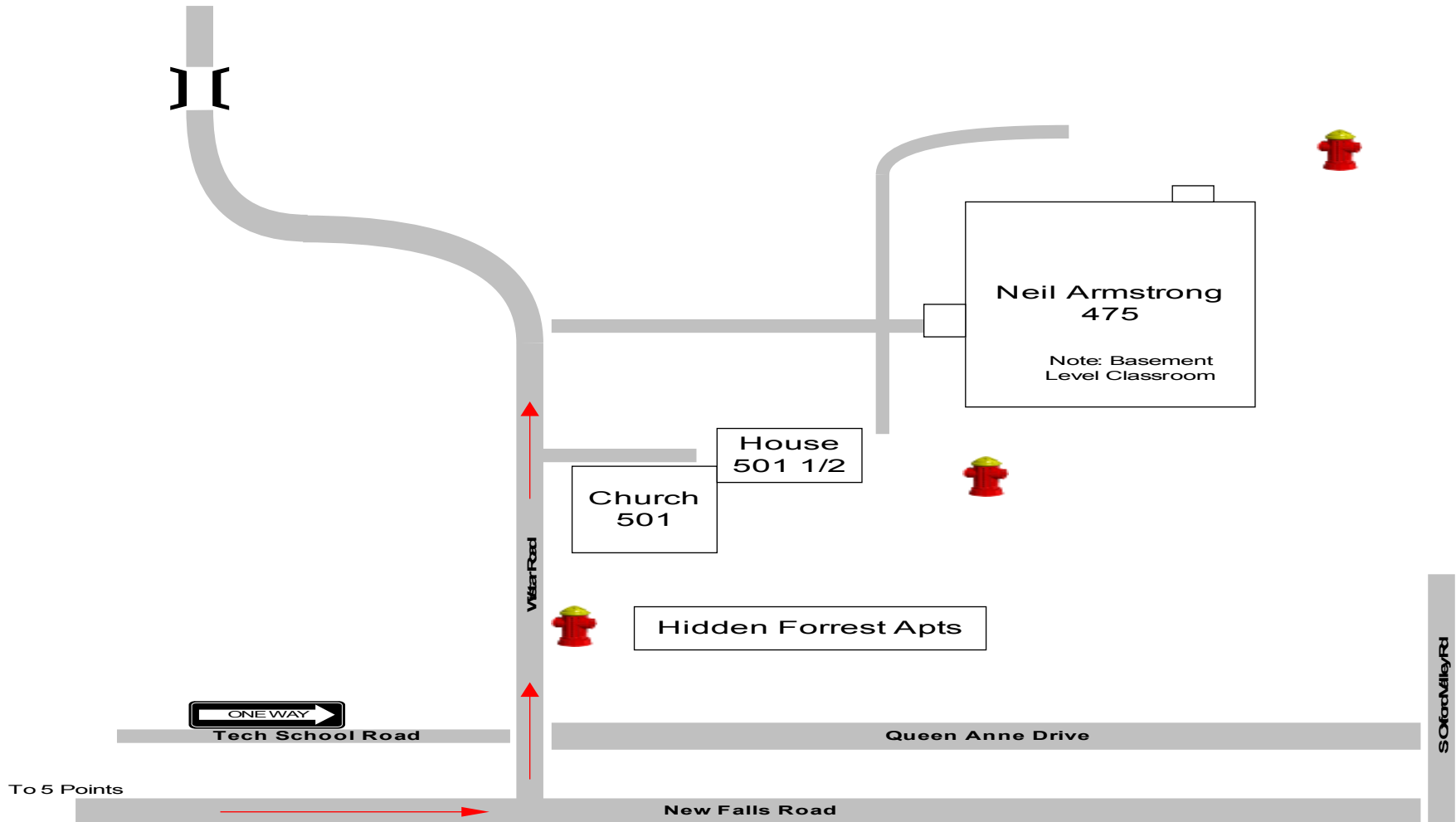

1st Due:
E13,E82,E77
L10,L14
R12,R53,SQ154
Rit R31

Immaculate Conception Church & School

3700 thru 5810 Emilie Rd

2nd Alarm:
E14,E52,E10
L53,L11
R32

13-96

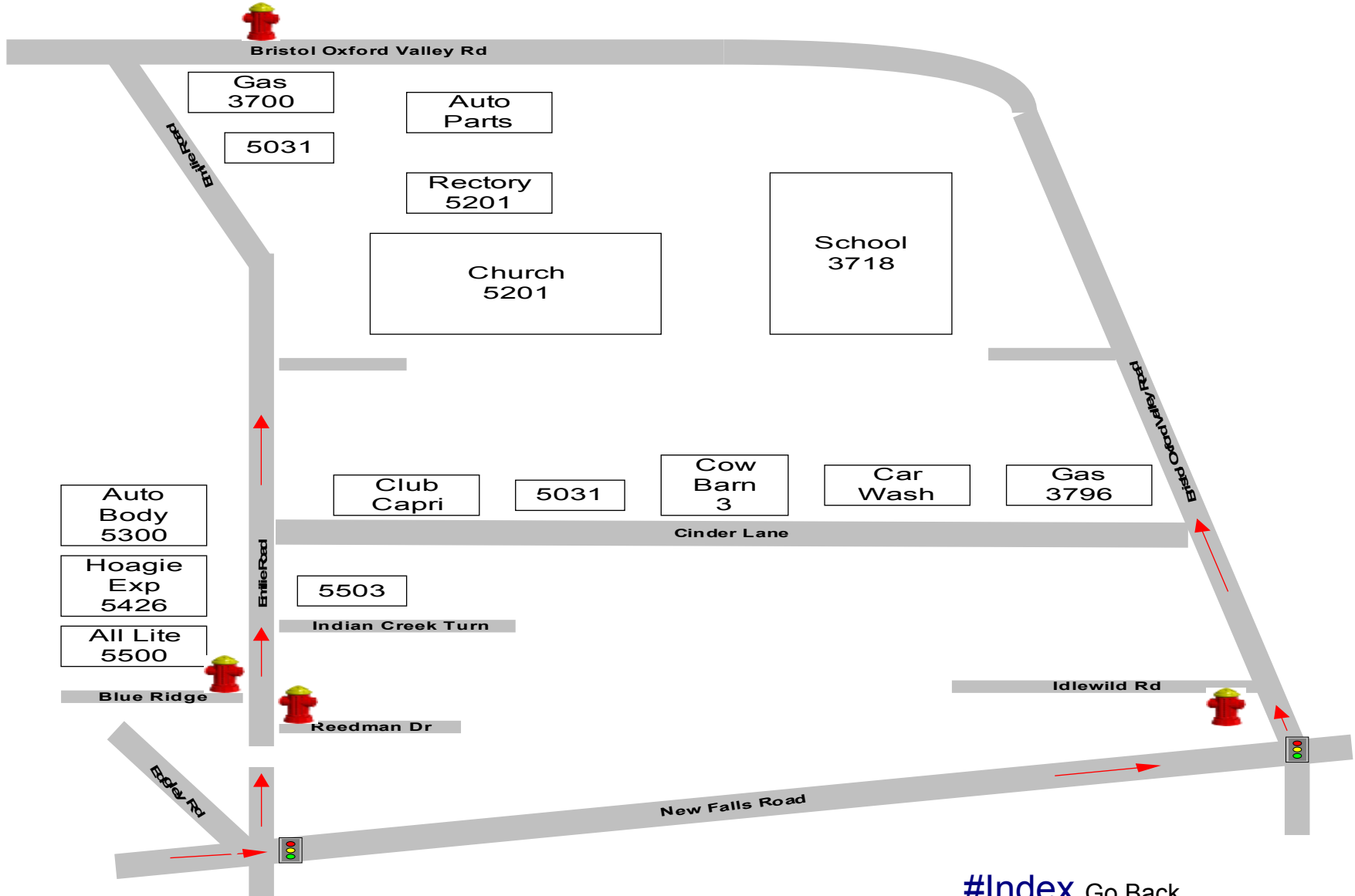

[#Index](#) Go Back